

MULTITYPE TERMINAL BLOCKS FOR POWER TRANSFORMERS **ZETTI** S.r.l.

CLUTCH CONNECTION

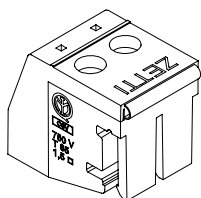

M-2P16IY
M-2P16IG

M-3P16IY
M-3P16IG

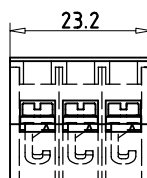
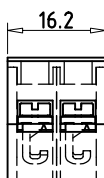

M-2P16SY
M-2P16SG

M-3P16SY
M-3P16SG

JERK CONNECTION

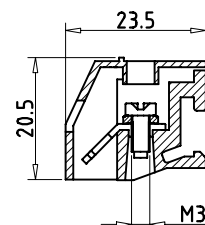

750V - 16A - T85

CONNECTING CABLE 1.5 mm²
APPROVED BY CSV-IMQ CA02.03645



CLUTCH CONNECTION

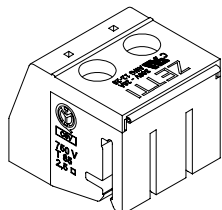

M-1P30IY
M-1P30IG

M-2P30IY
M-2P30IG

M-3P30IY
M-3P30IG

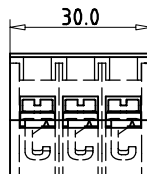
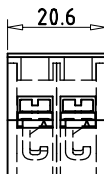
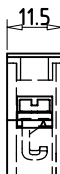

M-1P30SY
M-1P30SG

M-2P30SY
M-2P30SG

M-3P30SY
M-3P30SG

JERK CONNECTION

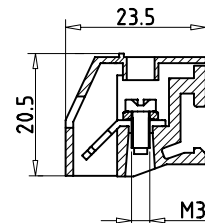

CONNECTING CABLE AWG 12-20
APPROVED BY XCFR2.E342781
APPROVED BY XCFR8.E342781

300V - 20A TORQUE 1.0-1.2 N.m



CONNECTING CABLE 2.5 mm²
APPROVED BY CSV-IMQ CA02.03644

750V - 20A - T85



CLUTCH CONNECTION

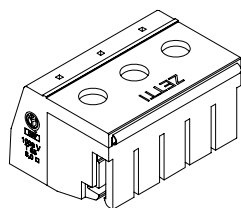

M-2P40 IY
M-2P40 IG

M-3P40 IY
M-3P40 IG

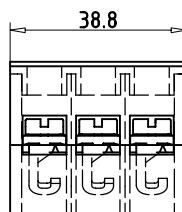
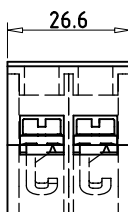

M-2P40SY
M-2P40SG

M-3P40SY
M-3P40SG

JERK CONNECTION

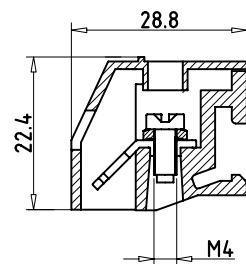

1000V - 36A - T85

CONNECTING CABLE 6 mm²
APPROVED BY CSV-IMQ CA02.03643



UNIPOLAR
CAR001

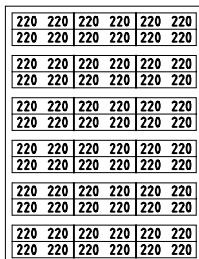

BIPOLAR
CAR002

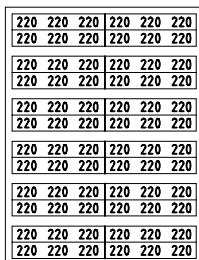

THREEPOLAR
CAR003

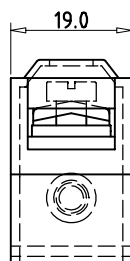

M-1P63SY
M-1P63SG

JERK CONNECTION

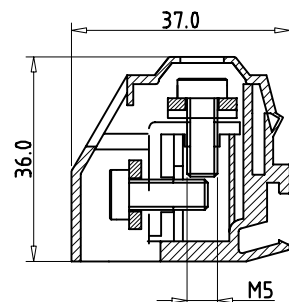

TORQUE 1.2-1.4 N.m
T85

CONNECTING CABLE 10 mm²

FUSE HOLDER 5x20 6.3A
CONNECTING CABLE 4 mm²

CLUTCH CONNECTION

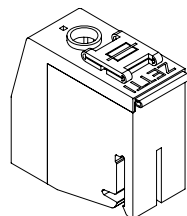

M-PFUSY
M-PFUSG
M-PFUY
M-PFUG

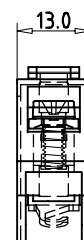

JERK CONNECTION

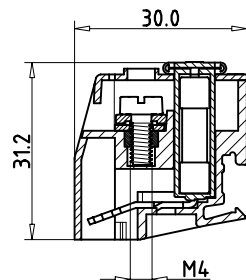

CODES DESCRIPTION

I = CLUTCH CONNECTION Y = ORANGE COLOUR
S = JERK CONNECTION G = GREY COLOUR

CAR00- WHITE OR WITH VOLTAGE MARKER
ON REQUEST